

Abstract of Deed dated July 18, 1811
Recorded March 10, 1813
Montgomery Co., N.Y. Book No. 13, Page 286-287

Grantors: William & Peggy Walrath, Christian & Maria Walrath, Oppenheim, Montgomery Co., N.Y.

Grantee: Conrad Hillegas, Oppenheim, Montgomery Co., N.Y.

Consideration: \$20.00

Description of land: Part of Lot 17 in the Francis Harrison Patent, in the Town of Oppenheim beginning on the division line between Lot 17 & Lot 18 by the Northerly edge of the Mohawk Turnpike then along the Turnpike Road, South 77 degrees East 2 chains & 38 links to a stake on the Northerly edge of the Turnpike then North 27 degrees & 30 minutes East to a wild cherry tree then forward the same course 6 chains & 41 links to a stake in a ditch and the division line then along the division line South 49 degrees West 7 chains & 38 links to the place of beginning containing 3 rods & 10 square rods of land more or less.

Witness: Cornelius C. Beekman, David Van Slyck

Note: William & Christian Walrath were brothers and the sons of John C. Walrath. William was married to Margaret Irving/Ervin. Christian was married to Marry Hillegas, daughter of Conrad Hillegas. She signed the deed Polly Walrath.

The distance from point 1 to point 2 was not given and so it was estimated to give the approximate size of the land.

3 rods = .75 acre 10 square rods=.1875 acre

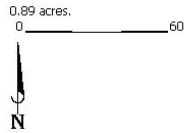

S 77 E 2.38 Chains
 N 27:30 E .2 Chains
 N 27:30 E 6.41 Chains
 S 49 W 7.38 Chains

the division line between Lot 17 & Lot 18 by the Northerly edge of the Mohawk Turnpike

