

Erie Canal Enlargement State of New York  
 County of Montgomery In the matter of the Claim of  
 Frederick Walrath before Thomas Clowes Chester Hayden  
 & Ambrose Salisbury Canal appraisers On the 7<sup>th</sup> day  
 of Oct 1843 at the village of Port Plain in said County  
 before the said appraisers came Frederick Walrath the  
 above named Claimant and presented his claim for  
 Canal damages against the state of New York & having  
 reviewed the premises & heard the proof & allegations  
 as well on the part of the said Claimant as of the  
 State from all which it appears that the claimant is  
 the owner of a farm in the town of Kinder in said  
 County through which the Erie Canal pass said farm  
 is bounded on the west by Poppe Cornelius & East  
 by Andrew Meyer in enlarging said Canal 1.80  
 acres of Claimants farm was permanently appropriated  
 for the and Earth for materials for the Canal was excavated  
 at two different places on said farm it also appears  
 that Claimants lots were thrown open by the State and  
 he thereby sustained an injury. The appraisers estimate  
 & award to the said Claimant for his damages as  
 follows Viz For land permanently appropriated \$44.00  
 Land excavated 40.00 Lots thrown open by the State 10.00  
 \$94.00 The aggregate of the sums above awarded is  
 ninety four dollars and the interest thereof for four  
 years & six months is \$29.61 Making in the whole the  
 sum of one hundred & twenty three  $\frac{1}{100}$  dollars which  
 last mentioned sum the appraisers estimate & award  
 to Claimant for his damages as specified in his said  
 claim The following are the filed notes of the Canal  
 survey including the premises embraced in this claim  
 The strong red lines are the base of the survey The one  
 on the township side of the canal is on the inner edge  
 of the tow path of the enlarged canal and that on  
 the same side of the canal is connected with it by

crop lines with the course and distance given the strong  
blue line represents the extreme limits of the appropriation  
for the <sup>the real</sup> ~~the~~ <sup>enlargement</sup> ~~enlargement~~ and the <sup>colored</sup> ~~blue~~ <sup>lines</sup> ~~represent~~ <sup>the</sup> ~~extreme~~ <sup>limits</sup> ~~of~~ <sup>the</sup> ~~appropriation~~  
ation, before the enlargement the distances are all  
given in chains & links the figures at the end of the  
the crop lines show the distance from the base line to  
the strong blue line and the figures on the crop lines  
show the distance along the base line from the last  
angle in said base line Given under our hands this  
14<sup>th</sup> day of december 1844 A. Salisbury C Hayden  
State of New York On this 21<sup>th</sup> day of december A.D 1844  
Albany County I <sup>3</sup> personally came before me Ambrose  
Salisbury and Chester Hayden to me known to be the  
persons described in and who executed the above trans<sup>cript</sup>  
and severally acknowledged to me that they had executed  
the same as their act and deed for the uses and purposes

223

therein mentioned Peter Ganscoort first Judge  
 Albany County Courts and Councillor of the Supreme  
 Court

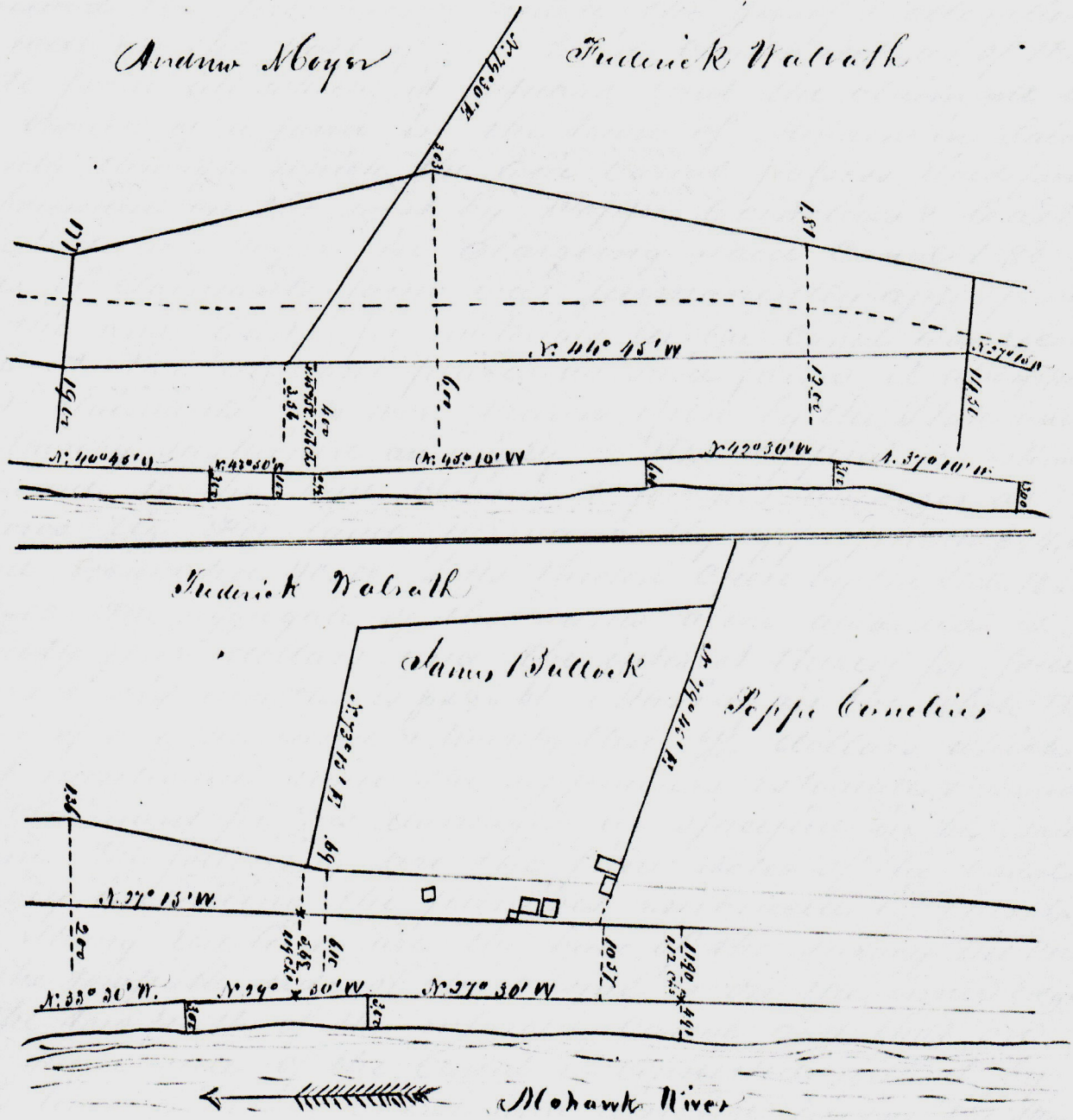

Recorded December 25<sup>th</sup> A.D. 1844 at 11 ante Meridian  
 J. Bramley Clerk